

Coolants, Lubricants & Fluid Maintenance

Cleaners	154
Coolant Pumps	157
Cutting Fluids	152-153, 155
Defoamer	154
Fluid Maintenance Equipment	154, 157-158
Layout Die	155
Lubricants	155-156

Blaser.
SWISSLUBE

KAR Starrett®

Graymills

Little GIANT

Anchor

Rapid Tap

Zebra Skimmers

A-9®

CUTTING FLUIDS

BLASOCUT

OUTSTANDING CUTTING PERFORMANCE

Blaser coolants are more concentrated so you use less product, therefore you have a much lower consumption rate with better performance, longer tool life and shorter cycle times.

FEATURES:

- High performance mineral oil-based micro-emulsions for extended tool life and superb surface finish
- Unique biological concept delivers long term stability without the need for tank side biocides
- Universal for machining and grinding of ferrous and non-ferrous materials
- Well suited for heavy duty and difficult operations such as deep hole drilling, broaching, reaming, creep-feed grinding & high speed machining
- Blaser's best for all around performance, stability, safety and ease of use
- Very low top-up rates
- Skin-friendly due to the mild bactericide-free Blasocut formulation

Blaser.
SWISSLUBE



Suitable for use with soft water

BLASOCUT BC 20 SW

- Water miscible, mineral oil-based high performance cutting fluid specially designed for use in soft water
- High performance cutting fluid for heavy duty machining of cast iron, steel and aluminum alloys
- Concentrate contains calcium which acts as anti-foaming agent in soft water

BLASOCUT BC 25 SW

- Water miscible, chlorine free, mineral oil-based cutting fluid especially designed for use in soft water
- Designed for general machining of cast iron, steel and aluminum alloys
- Concentrate contains calcium which acts as anti-foaming agent in soft water

BLASOCUT BC 35 NF

- Water miscible, chlorine-free, mineral oil-based cutting fluid with superb foam control that is designed especially for use with soft water
- Designed for general machining of cast iron, steel and aluminium alloys
- Contains calcium, which acts as an anti-foaming agent in soft water
- Use with tap water hardness <90 ppm

BLASOCUT BC 40 SW

- Water miscible, mineral oil-based cutting fluid especially designed for use in soft water where good foam control is required
- High performance cutting fluid designed for medium to heavy duty machining of cast iron, steel and aluminum alloys
- Use with tap water hardness <180 ppm

BLASOCUT 2000 CF SW

- Water miscible, chlorine-free, mineral oil-based cutting fluid especially designed for use with soft water
- Universal cutting fluid designed for general machining of cast iron, steel, aluminum as well as copper containing and aerospace alloys
- Concentrate contains calcium that acts as an anti-foaming agent in soft water



CUTTING FLUIDS



BLASOCUT

OUTSTANDING CUTTING PERFORMANCE

Suitable for use with hard water

BLASOCUT BC 20

- Water miscible, mineral oil-based cutting fluid
- Cutting fluid designed for medium to heavy duty machining of cast iron, steel and aluminum alloys, for high request on surface finish and tool life

BLASOCUT BC 935

- Water-miscible, mineral and ester oil based, boric and chlorine free cutting fluid with minimal residue
- Characterized by a very robust pH stability
- Universal cutting fluid for machining and grinding of steel, cast iron and is also applicable for mixed manufacturing with aluminum alloys
- Ideal for single machines and central systems

BLASOCUT BC 940

- High performance water-miscible, mineral and ester oil based, boron free cutting fluid with excellent cleanliness
- Characterized by good pH- and bio stability
- Suitable for both soft and hard water
- Universal cutting fluid for machining and grinding of steel, cast iron and is also applicable for manufacturing with aluminum alloys
- Ideal for single machines and central systems



SPECIFICATIONS	BC 20	BC 20 SW	BC 25 SW	BC NF 35	BC 40 SW	BC 935	BC 940	2000 CF SW
Foam control in soft water <180 ppm	good	very good	very good	excellent	very good	conditional	conditional	good
Suitable for hard water >200 ppm	yes	no	no	no	no	yes	yes	no
Hard metals / tough alloys	very good	very good	good	good	excellent	very good	superior	good
Soft aluminum / < 2% Si content	very good	very good	very good	very good	very good	very good	very good	very good
Copper alloys	conditional	conditional	conditional	conditional	conditional	conditional	conditional	conditional
Steel / irons	yes	yes	yes	yes	yes	yes	yes	yes
Aluminum / non-ferrous	yes	yes	yes	yes	yes	yes	yes	yes
Grinding < 200 grit wheel	yes	yes	yes	yes	yes	yes	yes	yes
Grinding > 200 grit wheel	conditional	conditional	yes	yes	conditional	yes	conditional	yes
Concentration range	5-15	5-15	5-15	5-15	5-15	3-15	3-15	5-20
Refractometer factor	1	1	1	1	1	1	1	1
Refractometer range	5-15	5-15	5-15	5-15	5-15	3-15	3-15	5-20
18.7 L ORDER #	BLA-12000519L	BLA-12006519L	BLA-12506519L	BLA-135119L	-	-	BLA-194019L	BLA-8752119L
PRICE	\$161.56	\$161.56	\$158.91	\$190.82	-	-	\$192.02	\$166.84
208 L ORDER #	BLA-120005	BLA-120065	BLA-125065	BLA-1351	BLA-40018	BLA-1935	BLA-1940	BLA-87521
PRICE	\$1,599.47	\$1,559.47	\$1,573.25	\$1,717.47	\$1,704.36	\$1,835.46	\$1,901.01	\$1,501.58

B-COOL 755

IDEAL FOR HIGH CUTTING SPEEDS & HIGH PRESSURE CONDITIONS

FEATURES:

- Semi-synthetic, water miscible, chlorine free, medium mineral oil containing cutting fluid
- Characteristics of this product are low foaming behavior in hard and soft water with good stability, good corrosion protection and low consumption
- Designed for machining of soft aluminum alloys, titanium, nickel-based alloys, heat-resistant steels and stainless steel
- Ideal for single machines and central systems



SPECIFICATIONS	B-Cool 755
Foam control	excellent
Suitable for hard water >200 ppm	yes
Hard metals / tough alloys	excellent
Soft aluminum / < 2% Si content	excellent
Copper alloys	conditional
Steel / irons	yes
Aluminum / non-ferrous	yes
Grinding < 200 grit wheel	yes
Grinding > 200 grit wheel	yes
Concentration range	5-15
Refractometer factor	1.0
Refractometer range	5-15
Size	208 L
ORDER #	BLA-11755
PRICE	\$2,400.40

Call our Customer Service Team at
1-866-999-3117 for all your Cutting Fluid needs.



CLEANERS & DEFOAMERS



BLASOCLEAN AF LOW FOAM ALKALINE SYSTEM CLEANER

FEATURES:

- Alkaline additive for water miscible cutting fluids, semi-synthetics and emulsions
- Can be used as stabilizer of the coolant as well as system cleaner for machines



SIZE	ORDER #	PRICE
3.78 L	BLA-2917001	\$59.97
18.90 L	BLA-29170015	\$293.10

DEFOAMER ANTIFOAMING AGENT FOR AQUEOUS INDUSTRIAL FLUIDS

FEATURES:

- For use in any machine or cleaning operation that has eliminated defoamer related problems with respect to painting or processed parts
- Adhesion of the paint to the metal substrate is not impaired nor is there any development of "fish eyes" or other surface imperfections in the coated surface

SIZE	ORDER #	PRICE
3.78 L	BLA-XTD2821-L	\$33.78

CALCIUM DEFOAMER CALCIUM ACETATE SOLUTION

FEATURES:

- Ready to use Calcium Acetate solution for hardening up of mineral oil based Blasocut and B-Cool emulsions, acting as an anti-foam
- Effective long term anti-foam
- The water hardness, together with Blasocut and B-Cool forms fine calcium soaps, which effectively prevents foaming

SIZE	ORDER #	PRICE
3.78 L	BLA-29111/02-PL1	\$22.07

ACCESSORIES

REFRACTOMETER INDISPENSABLE AID

FEATURES:

- Indispensable aid for simple and quick measurement of the concentration of water-miscible cutting fluids
- Correct concentration of cutting fluids is a critical requirement for optimum performance
- Valuable aid in preventing possible problems within the production process
- Concentration can be read immediately with just one or two drops of the fluid placed on the surface of the prism and covered with the plastic cover the built-in eyepiece
- Reading is made by means of the border between light and dark zones on the scale
- Range of the instrument is 0-30%
- Requires practically no maintenance



SIZE	ORDER #	PRICE
Each	BLA-RBH32	\$120.77

JETMIX & MINIMIX EMULSION MIXING DEVICES

FEATURES:

- Ideal mixing device for preparing homogeneous and finely dispersed emulsions of cutting-fluid concentrate into water
- Correctly mixes proper emulsions at constant concentration
- Proper preparation of emulsion is required for the longevity and stability of cutting fluids
- Comes with wall mount



MINIMIX

- Economical version of the Jetmix for smaller customers (pails, drums) with the same mixing qualities as the Jetmix



DESCRIPTION	ORDER #	PRICE
Jetmix w/drum mount	BLA-9275PC	\$1,448.58
Minimix	BLA-9259	\$593.54
55 gal drum extension kit for Minimix	BLA-9255	\$75.36

Always ordering the same items?
Create a personalized Shopping List on our website
www.thomasskinner.com
to make ordering faster and easier!



Details on the inside back cover of this catalogue.



COOLANTS & FLUID MAINTENANCE

LUBRICANTS

ANCHORLUBE

FOR TOUGH CUTTING JOBS

FEATURES:

- Essentially free of chlorine, fluorine, lead, sulphur and silicone
- Formulated in distilled water for critical applications, odour is neutral, dermatitis problems are non-existent
- Washes off with water
- May be used on non-ferrous metals



SIZE	ORDER #	PRICE
8 oz tube	TON-ANCHOR8OZ	\$8.50
5 gallon pail	ANCHOR5GA	\$225.12

M1 INDUSTRIAL

ALL-PURPOSE



FEATURES:

- M1 produces a micro-thin, airtight coating/film that simultaneously dries as it protects, avoiding dirt, grim etc. That other "wet" lubricants actually attract
- **Lubricates:** M1 is free of silicone, making it an excellent lubricant. Its ability to stand up to extreme temperatures makes it ideal year-round
- **Penetrates:** Deep-down penetration works quickly to free frozen nuts, bolts, and metal parts. Actually gets under caked-on dirt to clean the metal for removal
- **Prevents rust:** protects metal against rust and corrosion damage by providing a molecular shield that locks to the metal
- **Cleans:** Actually removes grease, tar, and grime from metal parts and painted surfaces. Cleans and polishes for lasting protection
- **Nonconductive:** Prevents short circuits in high moisture environments, halts electrical leakage from wet ignition wires



DESCRIPTION	ORDER #	PRICE
12 oz aerosol can	STA-93201	\$83.02
5 gallon pail	STA-93227	\$231.10
53 gallon drum	93233	\$1,867.51

CUTTING FLUIDS

FOR ALUMINUM

EFFECTIVE FOR ANY MACHINE

FEATURES:

- Does everything for all types of aluminum and non-ferrous metals that Relton Rapid Tap does for rough metal and alloy steel
- Contains a scientific blend of chemicals that attach themselves to aluminum surfaces, forming an effective extreme-pressure boundary lubricant between tool and work surface
- Extends tool life, improves surface finish by eliminating scuff marks and gouging
- Leaves a surface which requires only ordinary cleaning to prepare for subsequent processing
- Contains no carbon tetrachloride, sulphur or chlorine



SIZE	ORDER #	PRICE
4 oz	JAM-A9114	\$3.05
1 pint	JAM-A9455	\$8.83
1 gallon	JAM-A94	\$47.57

TOOL & INSTRUMENT OIL

MODEL 1620



This oil is the same extra-fine lubricant made to our specifications and used in our factory to lubricate and protect our precision measuring tools and instruments.

FEATURES:

- General purpose lubricant for a wide range of applications
- Ideal for maximum protection and lubrication of measuring tools, precision instruments and light machinery
- Guards highly finished tools, parts and machine surfaces against rust
- Protects firearms, fishing tackle and other sporting equipment and keeps working parts in perfect condition



DESCRIPTION	ORDER #	PRICE
4 fl oz plastic bottle	STA-53216	\$8.36

FOR METAL

HEAVY DUTY

FEATURES:

- Ozone friendly
- NO methyl chloroform (1,1,1 - trichloroethane)
- NON-toxic and NON-flammable
- Extra effective on those tough to drill metals and alloys such as beryllium, cast iron, inconel, magnesium, molybdenum, stainless steel and stellite
- Greatly extends tool life
- Super-fine machined finish



OZONE FRIENDLY



SIZE	ORDER #	PRICE
4 oz	JAM-RT114	\$4.07
1 pint	JAM-RT455	\$9.70
1 gallon	JAM-RT4	\$57.76

LAYOUT DYE

KLENSCRIBE - SERIES 610

DEEP BLUE, QUICK-DRYING DYE

FEATURES:



- Will not rub off on hands or clothing or flake away
- Unaffected by cutting lubricants and heat generated during machining
- To remove, use a rag or wiper, moistened with denatured alcohol

Ideal for numerous applications:

- Laying out dies, cams, templates, jigs, fixtures, patterns, castings
- Touching cutting tool to work before setting machine for cut
- Checking alignment of gears and wearing parts



DESCRIPTION	ORDER #	PRICE
4 oz plastic bottle	STA-53212	\$10.57
11.5 oz areosol can	STA-55896	\$21.15

INDUSTRIAL QUALITY LUBRICANTS

MOBILE OIL DTE 25

HIGH QUALITY HYDRAULIC OIL

This high quality hydraulic oil was developed specifically for severe hydraulic systems using high-pressure, high output pumps. Provides superior antiwear and film characteristics necessary for critical systems.

USES:

- For most hydraulic industrial applications including high-pressure systems, systems with servo valves, and all robotics
- For use on all Haas machines - transmission, gearbox and lathe turrets

MOBILE OIL DTE LIGHT

PREMIUM PERFORMANCE CIRCULATING LUBRICANT

Premium performance circulating lubricant. Formulated from highly refined base stocks and an additive system which provide an extremely high level of chemical and thermal stability, rapid and complete separation from water and a high resistance to emulsification.

USES:

- Designed for applications including steam and hydro turbine sets and other systems where long lubricant service life is required

MOBILE OIL GEAR SHC 634

UNIQUE & PROPRIETARY SYNTHETIC BASED OIL TECHNOLOGY

Formulated using a unique and proprietary synthetic base oil technology add additives that enhance oxidation stability, improves foam control, maintains superior stability in the presence of water, and provide protection against rust, corrosion, and wear.

USES:

- Recommended for industrial bearings and gears over the widest range of operating temperatures
- Particularly effective where high oil temperatures result in short oil life and high maintenance costs for parts replacement, system cleaning, and lubricant changes



Not exactly as shown



Call our Customer Service Team at **1-866-999-3117** for all your lubrication needs.



Not exactly as shown

MULTI-WAY OIL HD 68

PREMIUM LUBRICANT

This circulating oil was developed for the lubrication of lathes and heavily loaded machine tool slideways. It is specially formulated to prevent stick-slip problems to ensure good surface finish on the machined part. Compatible with Mobil Oil Vactra 2.

USES:

- Horizontal and vertical slideways on machine tools, such as lathes, planers, shapers, drilling machines, milling machines and screw machines
- May be used as a combination way oil, hydraulic oil and gear oil in machine tools where the circulating oil is supplied from a central reservoir

SHELL TELLUS 32

PREMIUM QUALITY MINERAL OIL

Premium quality solvent refined, high viscosity index mineral oil. 32 ISO viscosity.

USES:

- Designed for use in all types of hydraulic and fluid power lubrication

SHELL TELLUS 46

PREMIUM QUALITY MINERAL OIL

Premium quality solvent refined, high viscosity index mineral oil. 46 ISO viscosity.

USES:

- Designed for use in all types of hydraulic and fluid power lubrication
- Good for conventional machine gear boxes

LRL-3

GREASE

Multi-temperature grease.

USES:

- For Okuma ball screws and linear guides

PRODUCT	SIZE	ORDER #	PRICE
Mobil Oil DTE 25	20 L	MRS-DTE2519L	\$107.55
Mobil Oil DTE Light	19 L	MRS-MOBILDTELIGHT	\$90.99
Mobil Oil Gear SHC 634	19 L	SHC634	\$289.00
Way Oil 76 HD 68	20L	UWO68P	\$122.92
Shell Tellus 32	18.9 L	SHE-TELLUS3220L	\$109.00
Shell Tellus 46	18.9 L	SHE-TELLUS4620L	\$104.00
LRL-3	16 oz	SEN-LRL3	\$43.04



COOLANT PUMPS

MODEL HR35A

FOR THIN LIQUIDS & ABRASIVES

HR Series pumps are widely used for circulating thin liquids and abrasives. Impellers are open type. No bearings, packings or seals below liquid level.

FEATURES:

- 1/25 HP, 1,500 RPM, 1/2" NPT horizontal discharge
- 8" column height centrifugal pump
- Maximum viscosity: 150 SSU
- Pump body and volute are made of cast iron
- Shaft is made of carbon steel
- Impeller is glass-filled celcon



DESCRIPTION	ORDER #	PRICE
1/25 HP, 1,500 RPM	HR35A	\$335.80

PERMANENTLY LUBRICATED PUMP

Dual purpose oil-filled pump that may be used totally submersed or in-line (fed w/pipe or hose)



LittleGIANT

FEATURES:

- 115V, 1/40 HP
- Pumps 5 gallons per minute
- 300 GPH @ 1 ft
- Epoxy-coated aluminum housing

ORDER #	PRICE
REF-502286	\$181.65

ACCESSORIES

COMPLETE HOSE ASSEMBLIES



1/4" & 1/2" SYSTEMS



DESCRIPTION	ORDER #	PRICE
1/4" hose assembly (approx 13") set includes: 1/16", 1/8", 1/4" nozzles & 1/8", 1/4" NPT connectors	KAR-217700	\$19.47
1/2" hose assembly (approx 13") set includes: 1/4", 3/8", 1/2" nozzles & 3/8", 1/2" NPT connectors	KAR-217701	\$22.30

Graymills

IMS & IMV SERIES

DEPENDABLE PUMPS

IMS and IMV Series pumps are dependable, economical replacements for suction pumps commonly supplied as original equipment on foreign manufactured machine tools. All motors are completely protected from soil and dust, and feature permanently lubricated, sealed bearings.

FEATURES:

- Maximum viscosity: 500 SSU
- Pump body and volute are made of cast iron
- Shaft is made of carbon steel
- Impeller for IMS/IMV08 and 25 is made of plastic
- Impeller for IMS/IMV50, 75 and 100 is made of aluminum
- 3450 RPM for all models
- Refer to Voltage Suffix Chart

IMS SERIES (SUCTION STYLE)



IMS08

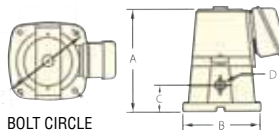

BOLT CIRCLE

MODEL	HP/KW	MAX FLOW	VOLTAGE	ORDER #	PRICE
IMS08	1/8 (.09)	9.5 GPM	E	GRA-IMS08E	\$225.00
IMS08	1/8 (.09)	9.5 GPM	F	IMS08F	\$221.95
IMS25	1/4 (.19)	20 GPM	E	GRA-IMS25E	\$352.50
IMS25	1/4 (.19)	20 GPM	F	IMS25F	\$337.50
IMS50	1/2 (.37)	32 GPM	E	GRA-IMS50E	\$519.68
IMS50	1/2 (.37)	32 GPM	F	GRA-IMS50F	\$506.88
IMS75	3/4 (.56)	43 GPM	F	IMS75F	\$765.90
IMS100	1 (.75)	48 GPM	F	IMS100F	\$903.90

IMV SERIES (IMMERSION STYLE)



BOLT CIRCLE

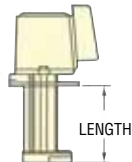

LENGTH	MODEL	HP/KW	MAX FLOW	VOLTAGE	ORDER #	PRICE
6"	IMV08	1/8 (.09)	10 GPM	E	GRA-IMV08E	\$242.70
6"	IMV08	1/8 (.09)	10 GPM	F	GRA-IMV08F	\$165.00
6"	IMV08	1/8 (.09)	10 GPM	Z	IMV08Z	\$169.05
7"	IMV25	1/4 (.19)	20 GPM	E	IMV25E	\$368.00
7"	IMV25	1/4 (.19)	20 GPM	F	GRA-IMV25F	\$352.00
9 1/2"	IMV50	1/2 (.37)	35 GPM	E	IMV50E	\$621.00
9 1/2"	IMV50	1/2 (.37)	35 GPM	F	IMV50F	\$603.75
11"	IMV75	3/4 (.56)	45 GPM	F	IMV75F	\$733.70
11"	IMV100	1 (.75)	50 GPM	F	IMV100F	\$868.25

VOLTAGE SUFFIX CHART

SUFFIX	LENGTH	E	F	Z	GAME	GAMC
VOLTAGE	230	115/230	230/460	575	air motor	56C face air motor
HERTZ	60	50/60	50/60	60	-	-
PHASE	1	1	3	3	-	-

Need additional information? Check out our website or call 1-866-999-3117.



FLUID MAINTENANCE EQUIPMENT



Cleans your coolant and saves you money using low cost solutions and world class expertise.

BELT SKIMMER

OIL SKIMMER FOR COOLANT CLEANING

Belt oil skimmer for coolant cleaning. Mounts directly on sump or drum, even through the bung hole of a barrel. Belt is made of unbreakable plastic that won't slip or stretch like others. Comes in four standard sizes - 8", 12", 18", 24".

FEATURES:

- Continuous-duty fan-cooled motor
- Removes about 1 gallon oil per hour wiping BOTH sides of the belt
- Self-tensioning belt

Contact Thomas Skinner for information about other sizes available.



DESCRIPTION	ORDER #	PRICE
8" belt skimmer	ZEB-BPF108	\$466.83
8" replacement belt	BP08	\$59.67
12" belt skimmer	BPF112	\$478.53
Blade wiper set (2/set)	BXWIP	\$21.06

SIDEWINDER® TUBE SKIMMER

SKIMS FROM ANYWHERE

This mechanical skimmer skims underneath conveyors, enclosed sumps, and hard-to-access areas.

FEATURES:

- Installs in seconds
- Industrial-grade pick-up tubing uses ceramic scraper
- Large oil discharge port
- Continuous-duty motor
- Reach: 8"
- Capacity: 1 qt/hr
- Application: coolant



ORDER #	PRICE
ZVA808	\$455.13

THE DIVERTER™

BRAIN TRANSPLANTS FOR SKIMMERS

Turn ordinary belt or tube skimmers into "smart" ones by using The Diverter. Returns coolant back to the sump so that you dispose of pure waste oil. Saves you money on expensive coolant.

FEATURES:

- Saves you nearly \$300 per year
- Knows the difference between floating tramp oils and coolant
- Discharge pipes and mounting hardware included
- Rugged steel construction



ORDER #	PRICE
ZEB-BGST4	\$115.83

SMART DISK SKIMMER

SEPARATES OIL FROM COOLANT

Separates oil from coolant and returns the clean coolant to the sump. Increases coolant life and reduces disposal costs. Saves time and labour.

FEATURES:

- Saves you nearly \$300 per year over other Disk Skimmers
- Integrated Diverter knows the difference between floating tramp oils and coolant
- Continuous-duty, fan-cooled motor
- Rugged steel construction
- 2 quarts per hour removal capacity

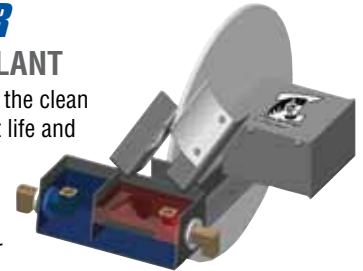

ORDER #	PRICE
ZEB-GS4H300	\$373.23

ECONOMY MIXER

COOLANT MIXER

Properly mixing provides better emulsions and saves on raw material costs.

FEATURES:

- 14 metering tips for specific ratios
- Maximum viscosity of 500 SUS
- 30 day warranty only
- 48" discharge tube included (max length for delivery)
- Application: barrel, pail or tote



GPM	MIX RANGE %		RANGE PSI	FITTINGS, NPT		ORDER #	PRICE
	LOW	HIGH		IN	OUT		
4.8	.25	22.2	25-75	3/4" GHT	1/2" NPT	MIX05120	\$174.33

ODOUR CONTROL TABLETS

END MONDAY MORNING SMELLS

FEATURES:

- Safe and easy to use
- Eliminate and prevent odours from hydrogen sulfide (rotten egg smell)
- Contains no formaldehyde or formaldehyde-releasing chemicals
- Safer and more economical than biocides
- Works best when used with Zebra Oxygenator™
- 15 tablets per tube



ORDER #	PRICE
ZEB-XOCT25	\$45.63